

**CERTIFIED LAND CORNER RECORDATION**

DESCRIPTION OF CORNER EVIDENCE FOUND, AND ORIGINAL RECORD (if known)

Record: Set a limestone 24x12x4 for corner to sections 23, 24, 25 and 26.

DESCRIPTION OF MONUMENT AND ACCESSORIES ESTABLISHED  
TO PERPETUATE THE ORIGINAL LOCATION OF THIS CORNER:

Found: loosely set limestone 18"x11"x8", 14" above ground marked with 2 notches on South edge and 1 notch on East face. Reset stone in found position 6" above ground.

Set: A red metal post 5.0' West.

SKETCH, WITH COURSE AND DISTANCE TO ADJACENT CORNER IF DETERMINED IN THIS SURVEY.  
(May Sketch or Paste Reproduction on Reverse Side.)

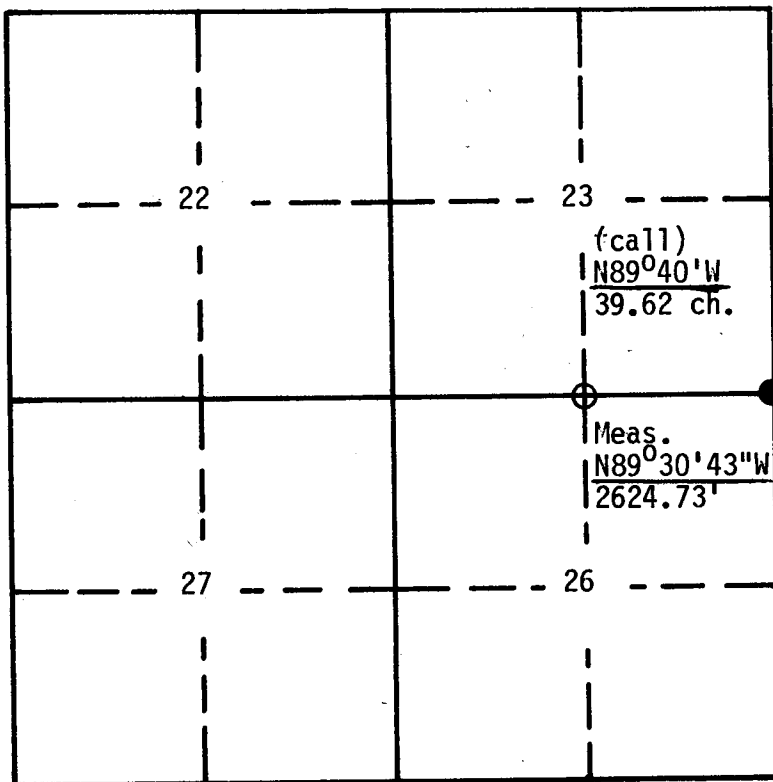

Section 23 T: 17N R: 66W

- corner filed--this form
- controlling corner

DETAILS

Basis of bearings were established from the record bearing between the Northwest and North ¼ section corners of Section 27, T17N R66W.

Surveyed: October 25, 1983

Job # 83105.000

I, Randall J. Rowley certify that I have carefully performed or reviewed the work done on the diagrammed corner as reported on this recordation form and approve the same.

Randall J. Rowley  
Signature of Surveyor 3888  
Registration No.

STATE OF WYOMING,  
Office of Clerk and Recorder,  
County of Laramie

**725442**

This "corner record" was filed for record on the DEC 9 day of 1983, 1983, was noted on the cross-index plat and is assigned page No.         , in book No.         .

Janet C. Whitehead  
County Official

Cross Index No. _____	T. _____	R. _____	Mer. _____
_____	T. _____	R. _____	Mer. _____
_____	T. _____	R. _____	Mer. _____
_____	T. _____	R. _____	Mer. _____
_____	T. _____	R. _____	Mer. _____
_____	T. _____	R. _____	Mer. _____
_____	T. _____	R. _____	Mer. _____

R-21